

LOCATION MAP
NO SCALE



VICINITY MAP

Source: Aerial Photography – <http://wms.alaskamapped.org/bdl/>
Alaska Statewide Digital Mapping Initiative



**QUINHAGAK SCHOOL
IMPROVEMENT PROJECT
Location & Vicinity Map**

Application by: LKSD
 Location: Quinhagak, Alaska
 Lat. 59.7517° N, Long. 161.8971° W
 USGS Goodnews (D-8) Alaska
 Township 5-S, Range 74-W, Section 8
 Seward Meridian
 Water Body: Kanektok River
 File No. POA-2013- 38
 DATE: January 2013 SHEET 1 OF 6

FILE: I:\193905\DWGS\WACOE PERMIT\NEW SCHOOL AND 4-PLEX\193905_QUIN-ACOE_FIG-02.DWG PLOTTED: Jan 17, 2013 - 3:06:06 PM (Cindi Pamome)

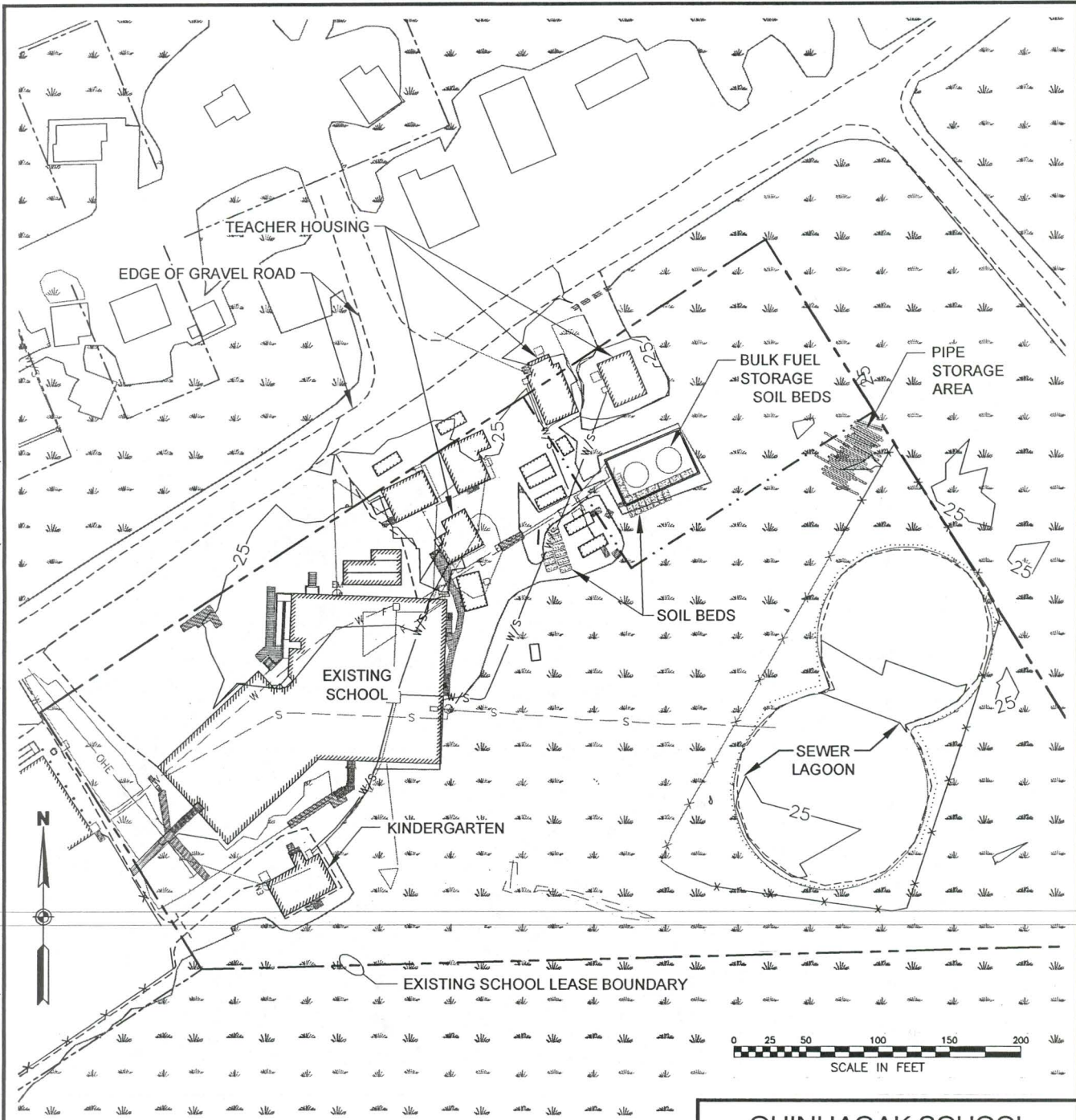

LEGEND

	EXISTING STRUCTURE
	WETLANDS
	SCHOOL PROPERTY BOUNDARY
	EDGE OF GRAVEL SURFACE

**QUINHAGAK SCHOOL
IMPROVEMENT PROJECT**
Existing Conditions

Application by: LKSD
 Location: Quinhagak, Alaska
 Lat. 59.7517° N, Long. 161.8971° W
 USGS Goodnews (D-8) Alaska
 Township 5-S, Range 74-W, Section 8
 Seward Meridian
 Water Body: Kanektok River
 File No. POA-2013-38
 DATE: January 2013 SHEET 2 OF 6

FILE: I:\1193905\DWGS\N\ACOE PERMIT\NEW SCHOOL AND 4-PLEX\1193905_QUIN-ACOE_FIG-03.DWG PLOTTED: Jan 17, 2013 - 5:17:41 PM (Cindi Pannone)

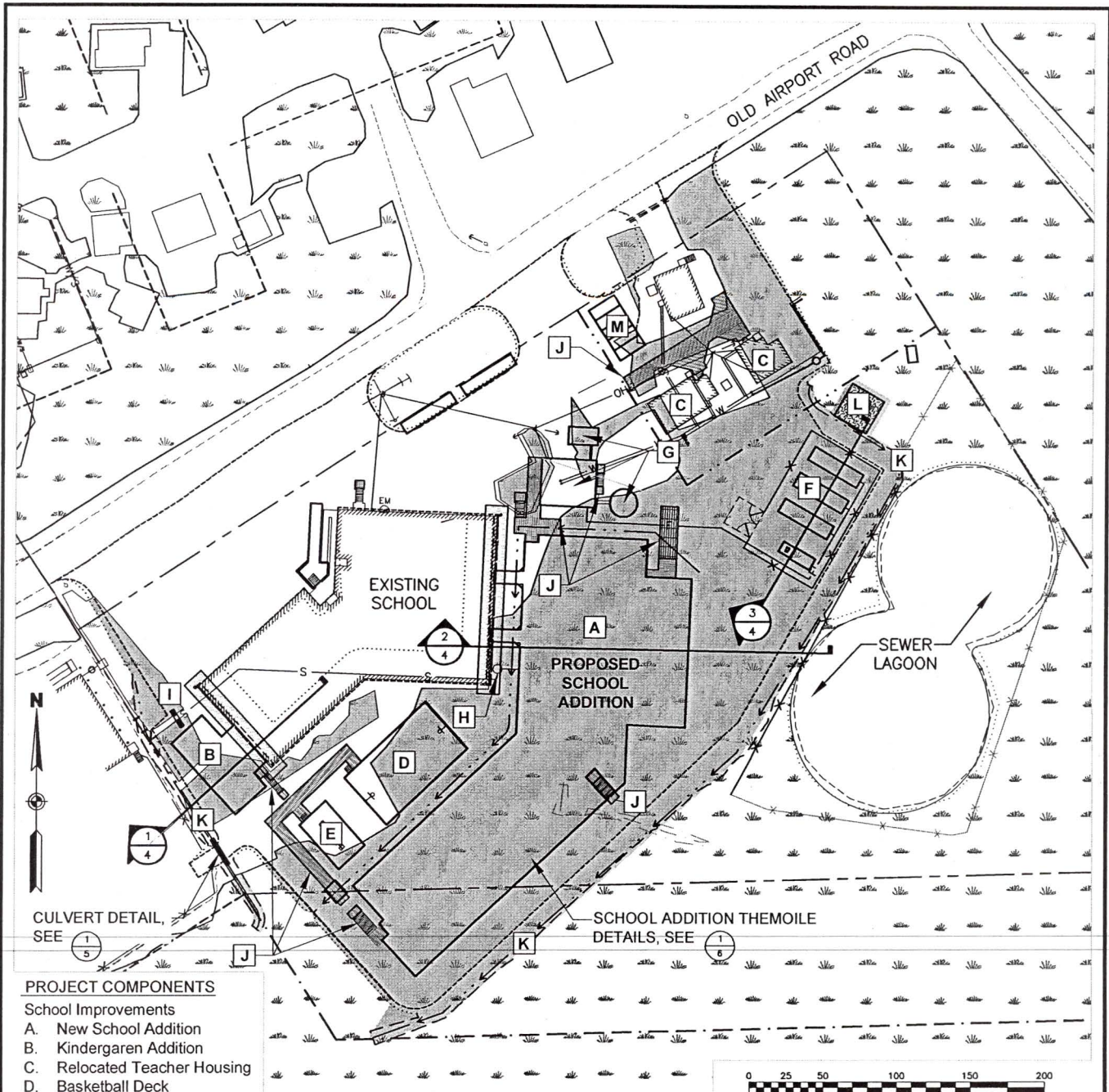

PROJECT COMPONENTS

School Improvements

- A. New School Addition
- B. Kindergaren Addition
- C. Relocated Teacher Housing
- D. Basketball Deck
- E. Play Deck

Utilities

- F. Tank Farm and Fence
- G. Water Storage Tank and Boiler, and Generator Modules
- H. Wastewater Grinder Pump Station

Pedestrian Access

- I. Relocated Footbridge
- J. Ramps, Boardwalks, and Stairs

Drainage

- K. Culverts and Drainage Swale

Storage

- L. Soil Stockpile Area
- M. Shipping Container Pad

LEGEND

- EXISTING STRUCTURE
- NEW / RELOCATED STRUCTURES
- WETLANDS
- AREA OF IMPACT



QUINHAGAK SCHOOL IMPROVEMENT PROJECT
Site Plan

Application by: LKSD
 Location: Quinhagak, Alaska
 Lat. 59.7517° N, Long. 161.8971° W
 USGS Goodnews (D-8) Alaska
 Township 5-S, Range 74-W, Section 8
 Seward Meridian
 Water Body: Kanektok River
 File No. POA-2013-38
 DATE: January 2013 SHEET **3** OF **6**

FILE: I:\1193905\DWGS\IN-ACOE PERMIT\NEW SCHOOL AND 4-FLEX\1193905_QUIN-ACOE_FG-04.DWG PLOTTED: Jan. 17, 2013 - 4:09:36 PM (Cindi Pannone)

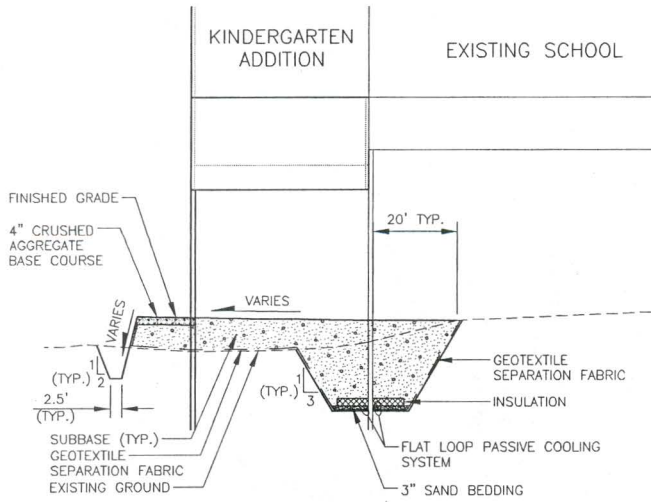

1 KINDERGARTEN ADDITION
4 SCALE: NTS

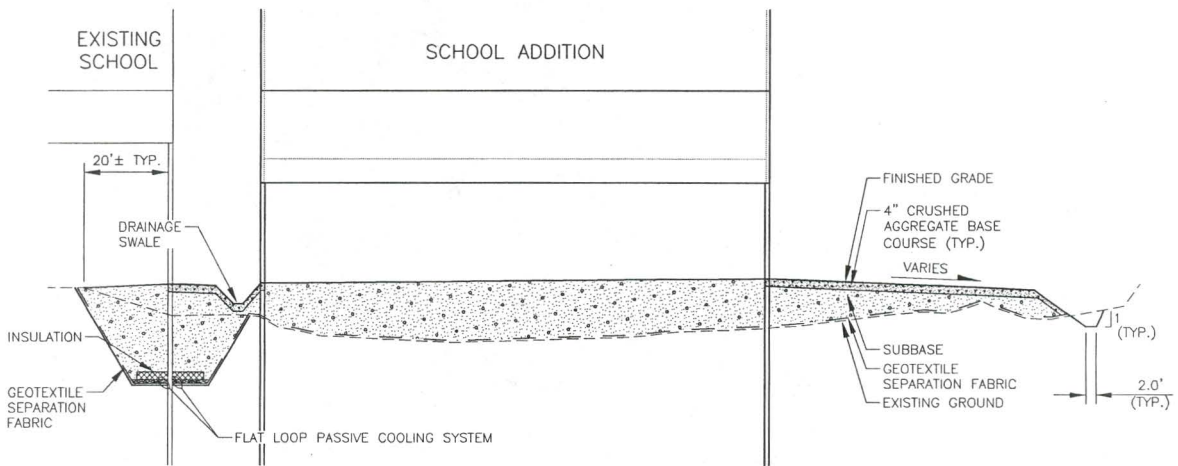

2 EAST SIDE SCHOOL ADDITION
4 SCALE: NTS

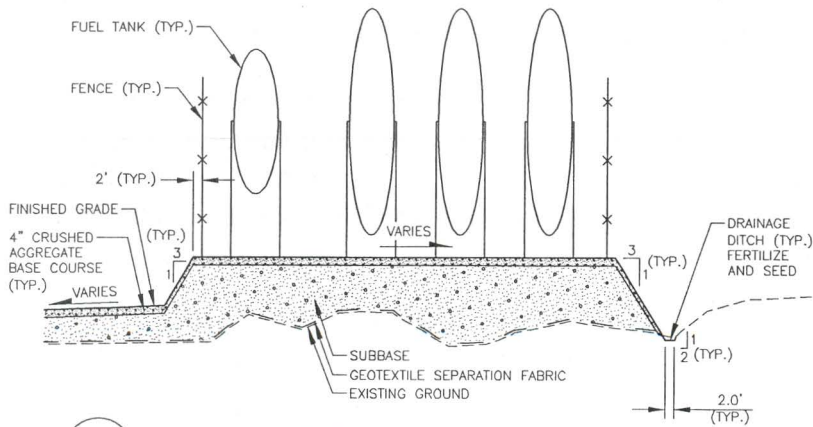

3 FUEL TANK PAD
4 SCALE: NTS

QUINHAGAK SCHOOL IMPROVEMENT PROJECT Site Sections

Application by: LKSD
 Location: Quinhagak, Alaska
 Lat. 59.7517° N, Long. 161.8971° W
 USGS Goodnews (D-8) Alaska
 Township 5-S, Range 74-W, Section 8
 Seward Meridian
 Water Body: Kanektok River

File No. POA-2013- 38

DATE: January 2013

SHEET **4** OF **6**

FILE: I:\1193905\DWGS\N\ACOE PERMIT\NEW SCHOOL AND 4-PLEX\1193905_QUIN-ACOE_FIG-05.DWG PLOTTED: Jan 17, 2013 - 4:13:08 PM (Cindi Pennone)

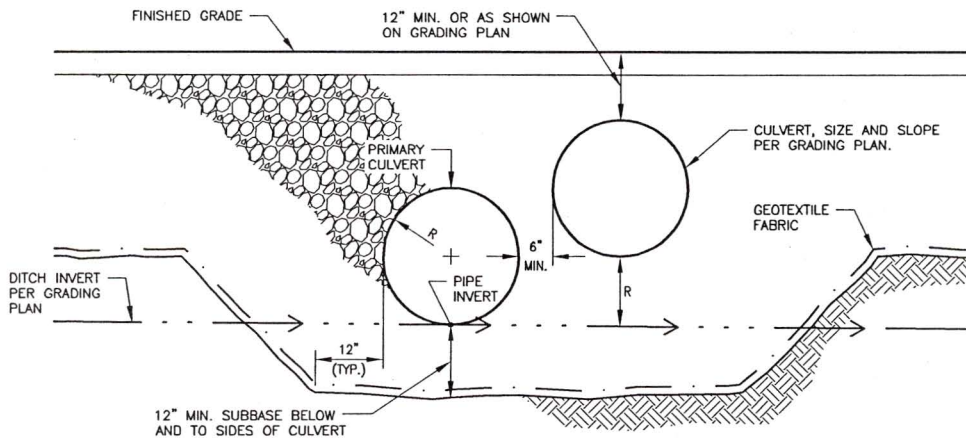

1
5 TYPICAL CULVERT
SCALE: NTS

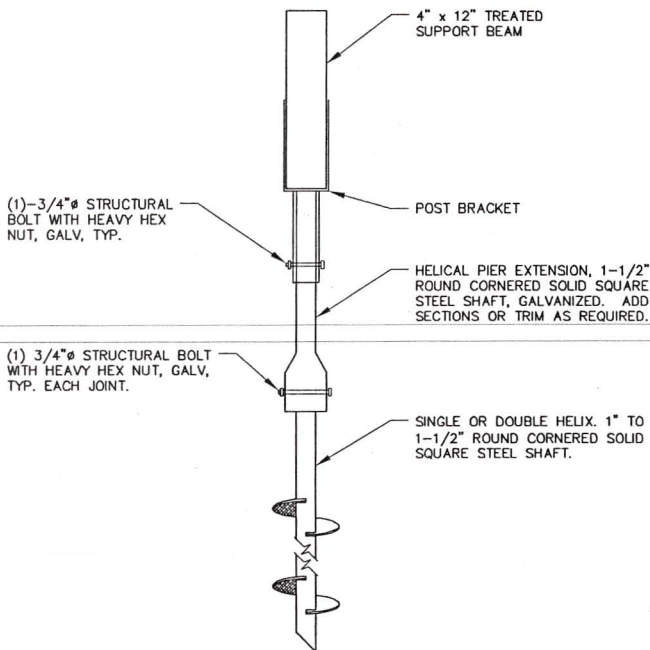

2
5 TYPICAL HELICAL PILE DETAIL FOR PIPE SUPPORTS, RAMPS, AND DECKS
SCALE: NTS

**QUINHAGAK SCHOOL
IMPROVEMENT PROJECT
Site Details**

Application by: LKSD
 Location: Quinhagak, Alaska
 Lat. 59.7517° N, Long. 161.8971° W
 USGS Goodnews (D-8) Alaska
 Township 5-S, Range 74-W, Section 8
 Seward Meridian
 Water Body: Kanektok River
 File No. POA-2013-38
 DATE: January 2013 SHEET 5 OF 6

FILE: I:\1193905\DWGS\WVACOE PERMIT\NEW SCHOOL AND 4-PLEX\1193905-QUIN-HACOE_FIG-06.DWG PLOTTED: Jan 17, 2013 - 4:44:41 PM (Citid: Pamone)

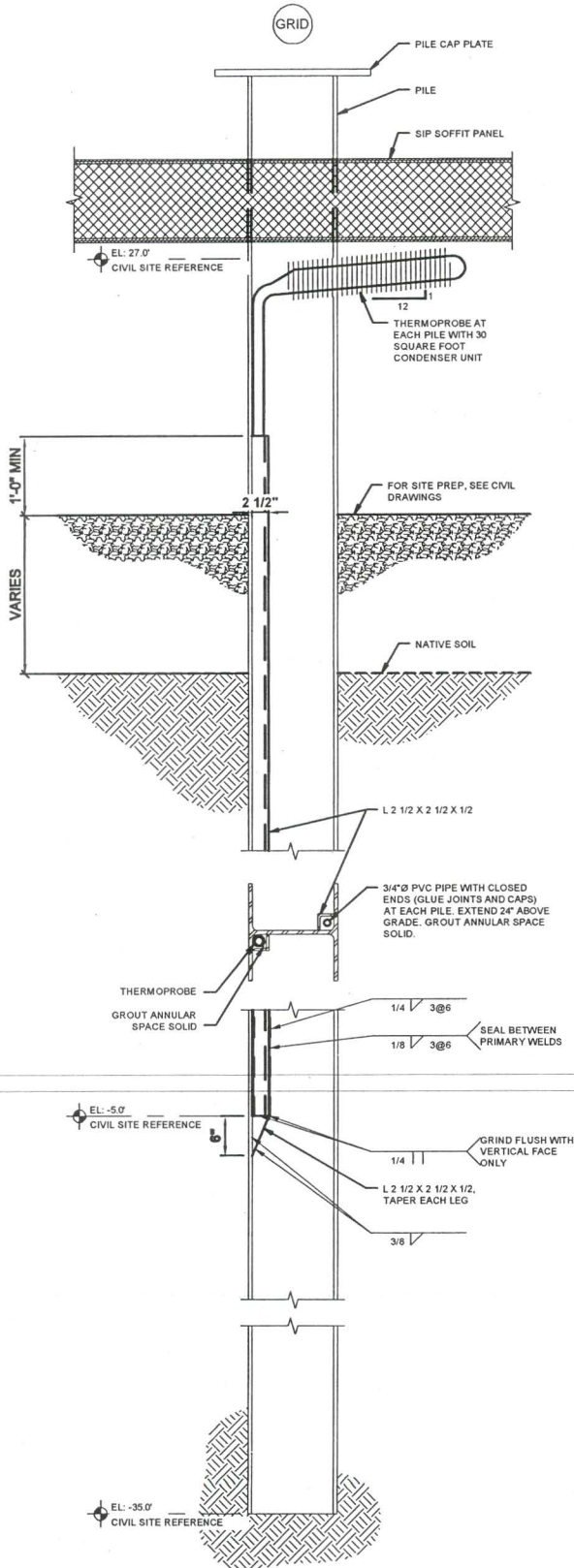

1
6 PILE -TYPICAL THERMOPILE FOR SCHOOL ADDITION
SCALE: NTS

QUINHAGAK SCHOOL IMPROVEMENT PROJECT Site Details

Application by: LKSD
 Location: Quinhagak, Alaska
 Lat. 59.7517° N, Long. 161.8971° W
 USGS Goodnews (D-8) Alaska
 Township 5-S, Range 74-W, Section 8
 Seward Meridian
 Water Body: Kanektok River

File No. POA-2013-38

DATE: January 2013

SHEET 6 OF 6